

AMENDED DRAWING

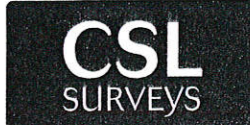

CONSULTING SURVEYORS
LAND-ENGINEERING-BUILDING

188 THORNER LANE ■ SCARCROFT ■ LEEDS
TEL 01132 893924 ■ TEL 07739 753 651
EMAIL INFO@CSLSURVEYS.CO.UK ■ WWW.CSLSURVEYS.CO.UK

TITLE		Topographical Survey Land Off Broach Lane Kellington			
CLIENT		Mrs Ruby Lee			
DATE	DRAWN BY	ACA	CHKD. BY	SA	
24/03/16					
PLOT SCALE		1 : 200 @ A1			
REV	AMENDMENT	DATE	BY	CHKD.	
A	Broach Lane added	29/08/18	ACA	SA	

NOTES

This survey is fitted to National Grid and Datum using GPS, and has been drawn at a scale factor of 1.0000.

Boundaries shown are physical features on site and do not necessarily represent the legal extents of ownership.

This drawing and the information contained therein is issued in confidence and is the copyright of CSL Surveys (Engineering) Ltd. Disclosure of this information to Third Parties without permission is forbidden as is copying or replication.



KEY

- B BOLLARD
- BT BRITISH TELECOM COVER
- CB CONTROL BOX
- CONC. CONCRETE
- DC DRAINAGE CHANNEL
- DK DROP KERB
- DP DOWN PIPE
- EP ELECTRICITY Pylon
- FL FLOOR LEVEL
- FH FIRE HYDRANT
- G GULLY
- GP GATE POST
- GV GAS VALVE
- H HEIGHT
- IC INSPECTION COVER
- IL INVERT LEVEL
- LP LAMP POST
- MH MANHOLE
- NB NOTICE BOARD
- RE ROOFING EYE
- RS ROAD SIGN
- RW RETAINING WALL
- TB TRAFFIC BOLLARD
- TL TRAFFIC LIGHT
- TP TELEGRAPH POLE
- UTL UNLITE TO LIFT
- WM WATER METER
- WO WATER OFFICE
- SV WATER STOP VALVE
- A SURVEY STATION
- BOREHOLE
- SOIL SAMPLE
- DIAMETER
- TRAIL HOLE/WT

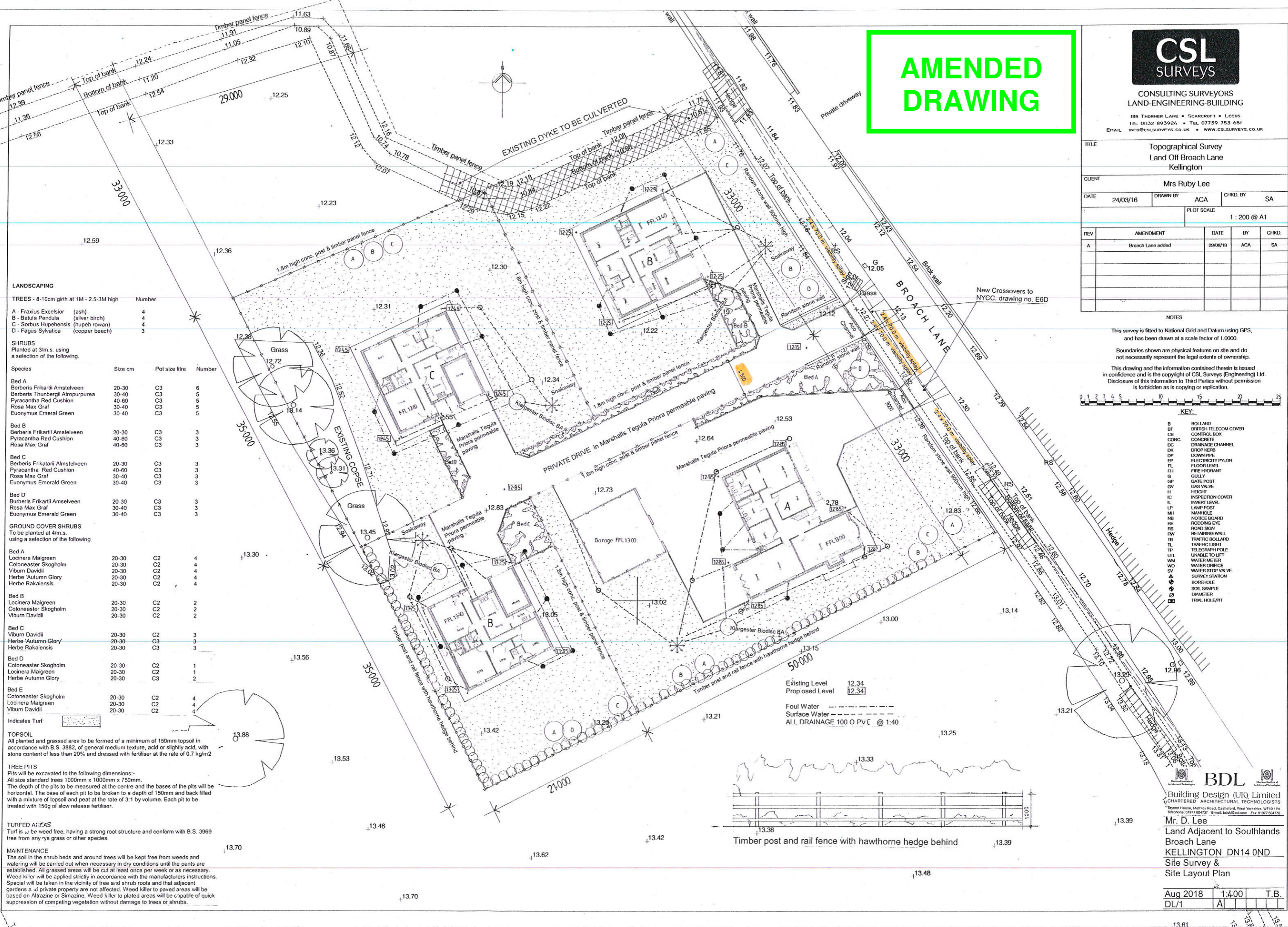

LANDSCAPING

TREES - 8-10cm girth at 1M - 2.5-3M high

Species	Number
A - Fraxius Excelsior (ash)	4
B - Betula Pendula (silver birch)	4
C - Sorbus Hupehensis (huphe rowan)	4
D - Fagus Sylvatica (copper beech)	3

SHRUBS
Planted at 3m.s. using a selection of the following.

Species	Size cm	Pot size litre	Number
Bed A			
Berberis Frikartii Amstelveen	20-30	C3	6
Berberis Thunbergii Atropurpurea	30-40	C3	5
Pyracantha Red Cushion	40-60	C3	5
Rosa Max Graf	30-40	C3	5
Euonymus Emerald Green	30-40	C3	5
Bed B			
Berberis Frikartii Amstelveen	20-30	C3	3
Pyracantha Red Cushion	40-60	C3	3
Rosa Max Graf	30-40	C3	3
Euonymus Emerald Green	30-40	C3	3
Bed C			
Berberis Frikartii Amstelveen	20-30	C3	3
Pyracantha Red Cushion	40-60	C3	3
Rosa Max Graf	30-40	C3	3
Euonymus Emerald Green	30-40	C3	3
Bed D			
Berberis Frikartii Amstelveen	20-30	C3	3
Rosa Max Graf	30-40	C3	3
Euonymus Emerald Green	30-40	C3	3
Bed E			
Cotoneaster Skoghalm	20-30	C2	1
Locinera Maigreen	20-30	C2	1
Herbe Autumn Glory	20-30	C3	2
Herbe Rakaiensis	20-30	C3	2
Bed F			
Locinera Maigreen	20-30	C2	4
Cotoneaster Skoghalm	20-30	C2	4
Locinera Maigreen	20-30	C2	4
Viburn Davidii	20-30	C2	4
Bed G			
Viburn Davidii	20-30	C2	3
Herbe Autumn Glory	20-30	C3	3
Herbe Rakaiensis	20-30	C3	3
Bed H			
Cotoneaster Skoghalm	20-30	C2	4
Locinera Maigreen	20-30	C2	4
Viburn Davidii	20-30	C2	4

GROUND COVER SHRUBS
To be planted at 4m.s. using a selection of the following

Species	Size cm	Pot size litre	Number
Bed A			
Locinera Maigreen	20-30	C2	4
Cotoneaster Skoghalm	20-30	C2	4
Viburn Davidii	20-30	C2	4
Herbe Autumn Glory	20-30	C2	4
Herbe Rakaiensis	20-30	C2	4
Bed B			
Locinera Maigreen	20-30	C2	2
Cotoneaster Skoghalm	20-30	C2	2
Viburn Davidii	20-30	C2	2
Bed C			
Viburn Davidii	20-30	C2	3
Herbe Autumn Glory	20-30	C3	3
Herbe Rakaiensis	20-30	C3	3
Bed D			
Cotoneaster Skoghalm	20-30	C2	1
Locinera Maigreen	20-30	C2	1
Herbe Autumn Glory	20-30	C3	2
Bed E			
Cotoneaster Skoghalm	20-30	C2	4
Locinera Maigreen	20-30	C2	4
Viburn Davidii	20-30	C2	4

Indicates Turf

TOPSOIL
All planted and grassed area to be formed of a minimum of 150mm topsoil in accordance with B.S. 3882, of general medium texture, acid or slightly acid, with stone content of less than 20% and dressed with fertiliser at the rate of 0.7 kg/m²

TREE PITS
Pits will be excavated to the following dimensions:-
All size standard trees 1000mm x 1000mm x 750mm.
The depth of the pits to be measured at the centre and the bases of the pits will be horizontal. The base of each pit to be broken to a depth of 150mm and back filled with a mixture of topsoil and peat at the rate of 3:1 by volume. Each pit to be treated with 150g of slow release fertiliser.

TURFED AREAS
Turf is to be weed free, having a strong root structure and conform with B.S. 3969 free from any ryegrass or other species.

MAINTENANCE
The soil in the shrub beds and around trees will be kept free from weeds and watering will be carried out when necessary in dry conditions until the plants are established. All grassed areas will be cut at least once per week or as necessary. Weed killer will be applied strictly in accordance with the manufacturers instructions. Special will be taken in the vicinity of tree and shrub roots and that adjacent gardens and private property are not affected. Weed killer to paved areas will be based on Altrazine or Simazine. Weed killer to planted areas will be capable of quick suppression of competing vegetation without damage to trees or shrubs.

Existing Level 12.34
Proposed Level 12.34

Foul Water
Surface Water
ALL DRAINAGE 100 O PVC @ 1:40

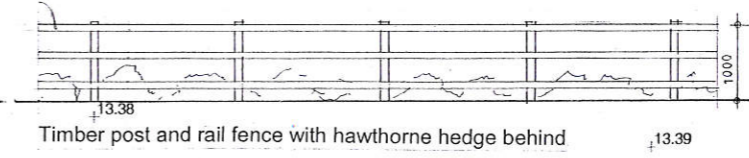

BDL
Building Design (UK) Limited
CHARTERED ARCHITECTURAL TECHNOLOGISTS
Taylors House, Malby Road, Castleford, West Yorkshire, WF10 1PA
Telephone: 01977 654137 E-mail: bdl@bdl.com Fax: 01977 654178

Mr. D. Lee
Land Adjacent to Southlands
Broach Lane
KELLINGTON DN14 0ND
Site Survey &
Site Layout Plan

Aug 2018	1:400	T.B.
DL/1	A	